



Summary

[Request a quote](#)

High Voltage	1
Wire Size/AWG	30 - 22
Socket / Receptacle	Socket / Receptacle - Fixed Panel Front Mounted
Locking system	Push-pull
Matching parts	FFA.0S.403.CLA52
Series	S - Indoor Stepped Insert

Technical details

Electrical Configuration

Termination	Solder
Insert configuration value	0S.403 - 1 High Voltage
Insulator	L: PEEK (UL 94 / V-0/1.5)
Rated current	4 Amps
Test voltage (kV AC)	4.2
Contact Type	Solder
Air clearance	6.8 mm
Creepage distance	7 mm
Contact Dia.	0.9
High Voltage	1
Wire Size/AWG	30 - 22

https://www.lemo.com/int_en/solutions/originals/s-indoor-stepped-insert/era-0s-403-cll.html

LEMO products and services are provided "as is". LEMO makes no warranties or representations with regard to LEMO product & services or use of them, express, implied or statutory, including for accuracy, completeness, or security. The user is fully responsible for his products and applications using LEMO components.

Form & Material

Shell style / Model id	ERA - Fixed receptacle, nut fixing
Socket / Receptacle	Fixed Panel Front Mounted
Housing material	Brass (chrome plated [SAE AMS 2460]) shell and collet nut, nickel plated [SAE AMS QQ N 290] brass latch sleeve and mid pieces
Locking system	Push-pull
Keying	Circular, female
Weight	4.18 g

Environment

Technical domain	Audio Video, Energy and Industrial, Semiconductor, Test and Measurement
Environmental protection	IP50
Temp (min / max)	-55°C / +250°C
Climatical Category	50/175/21
Humidity (max)	<=95% [at 60 deg C /140 F]
Shielding (min)	75 dB (10 MHz)
Shielding (min)	40 dB (1 GHz)
Shock Resistance	100 g [6 ms]
Vibration	15 g [10 Hz - 2000 Hz]
Salt Spray Corrosion	>1000 hr

Cable fixation

Cable termination protection	Standard back nut (no additional protection)
Fixation type	Cable collet

Drawings

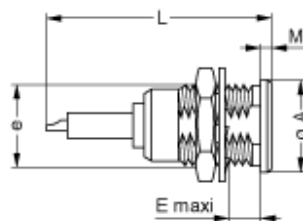
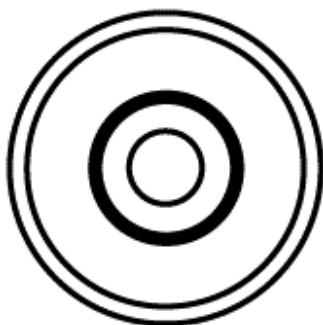

https://www.lemo.com/int_en/solutions/originals/s-indoor-stepped-insert/era-0s-403-cll.html

LEMO products and services are provided "as is". LEMO makes no warranties or representations with regard to LEMO product & services or use of them, express, implied or statutory, including for accuracy, completeness, or security. The user is fully responsible for his products and applications using LEMO components.

Dimensions

	A	e	E	L	M
mm.	10	M9x0.6	7	25	1.2
in.	0.39		0.28	0.98	0.05

Recommended By Lemo

Accessories

Tools

Spanner wrench

[Socket for torque wrench DCM.0S.M09.4](#)

https://www.lemo.com/int_en/solutions/originals/s-indoor-stepped-insert/era-0s-403-cll.html

LEMO products and services are provided "as is". LEMO makes no warranties or representations with regard to LEMO product & services or use of them, express, implied or statutory, including for accuracy, completeness, or security. The user is fully responsible for his products and applications using LEMO components.